



SOLAR Junior

Air-cooled condensers – commercial range

General information & application

Fincoil SOLAR Junior condensers have been designed for commercial refrigeration and AC applications. The range is especially suitable for places where easy assembly as well as a light and robust structure are required. The units are designed for outdoor use, but the structure and sound pressure levels make them also suitable for indoor use. The condensation effect may then be utilized for heating. SOLAR Junior condensers are available for both horizontal and vertical air flow.

Refrigerants	all H(C)FC
Capacities*	7.5 up to 265 kW

* R-404A, 15 K TD, EN327.

Coil

Coil manufactured from copper tubes \varnothing 12.7 mm and corrugated Alu-fins, tube pitch 35 x 30.31 mm. Standard fin spacing is 2.3 mm.

Casing

Casing of polyester coated, hot dip galvanised sheet steel, colour grey NCS 2502-B.

Fan motors

1 to 6 axial fans available in 4 different fan speed executions, diameters 350, 500 or 630 mm. Enclosed design fan motors, protection class IP-44.

Motors are wired to safety switches (IP65) at the end of the unit. All fans have corrosion resistant fan blades and fan guards.

Certifications

All condenser models are "Eurovent Certify All" certified. The Alfa Laval Vantaa quality system is in accordance with ISO 9001. All products are manufactured according to CE and PED rules.



SOLAR Junior

Test

Design pressure 26 barg. Each heat exchanger is leak tested with dry air.

Options

- Sub cooling section (Sub)
- Multi-circuiting (J#)
- Step control (SC)
- Fan speed control with frequency converter (SVC)
- Stepless variable fan speed control (VC)

Condenser selection & dimensions

Condenser selection is to be performed with our 'FincoilSelect' Air Heat Exchanger selection software.

Selection output includes all relevant technical data and dimensional drawings.



Dimensions & weights

coil size	fans		max. dimensions (mm)				fixing points (mm)					surface m ²	int. vol. l	no. of circuits	tube conn.		weight kg
	no.	ø	A	B	H	C	C1	C2	C3	D	E				in	out	
101	1	350	800	565	600	572				475	385	11.0	2.0	2	18	18	25
102	1	350	800	565	600	572				475	385	16.5	3.0	3	18	18	28
103	1	350	800	565	600	572				475	385	22.0	4.0	4	22	18	31
104	2	350	1400	565	600	1172				475	385	22.0	3.7	4	22	18	42
105	2	350	1400	565	600	1172				475	385	33.0	5.5	5	28	18	48
106	2	350	1400	565	600	1172				475	385	44.0	7.3	6	28	18	54
107	3	350	2000	565	600	1772				475	385	33.0	5.3	5	28	18	60
108	3	350	2000	565	600	1772				475	385	49.6	7.9	6	28	18	70
109	3	350	2000	565	600	1772				475	385	66.1	11	6	28	18	80
110	1	500	1025	895	900	772				810	515	23.5	4.1	5	28	18	60
111	1	500	1025	895	900	772				810	515	35.2	6.1	6	28	18	65
112	1	500	1025	895	900	772				810	515	49.6	8.2	8	35	22	70
113	2	500	1825	895	900	1572				810	515	47.0	7.6	8	35	22	100
114	2	500	1825	895	900	1572				810	515	70.5	11	12	35	22	110
115	2	500	1825	895	900	1572				810	515	94.0	15	12	35	22	125
116	3	500	2625	895	900	2372				810	515	70.5	11	16	35	22	135
117	3	500	2625	895	900	2372				810	515	106	17	24	42	28	155
118	3	500	2625	895	900	2372				810	515	141	22	21	42	28	175
119	1	630	1345	1095	1000	1092				1015	515	41.1	6.9	8	35	18	85
120	1	630	1345	1095	1000	1092				1015	515	61.6	10	10	35	22	95
121	1	630	1345	1095	1000	1092				1015	515	82.1	14	13	42	28	105
122	2	630	2465	1095	1000	2212				1015	515	82.2	13	13	42	28	140
123	2	630	2465	1095	1000	2212				1015	515	123	20	20	42	28	165
124	2	630	2465	1095	1000	2212				1015	515	164	26	20	42	28	185
125	4	630	3425	895	900	3172	1586	1586		1015	515	191	29	8	42	28	245
126	4	630	3425	895	900	3172	1586	1586		1015	515	255	39	11	42	28	270
127	4	630	3425	895	960	3172	1586	1586		1015	575	383	59	17	42	28	325
128	3	630	3585	1095	1000	3332	1106	2226		1015	515	253	38	10	42	28	285
129	3	630	3585	1095	1000	3332	1106	2226		1015	515	338	52	14	42	35	320
130	3	630	3585	1095	1060	3332	1106	2226		1015	575	507	78	21	42	35	400
131	4	630	4705	1095	1110	4452	2226	2226		1015	515	338	51	14	42	35	360
132	4	630	4705	1095	1110	4452	2226	2226		1015	515	451	68	19	54	35	410
133	4	630	4705	1095	1170	4452	2226	2226		1015	575	676	102	29	54	35	515
134	5	630	5825	1095	1110	3346	2226	1120	2226	1015	515	422	63	21	54	42	440
135	5	630	5825	1095	1110	3346	2226	1120	2226	1015	515	563	85	29	54	42	500
136	5	630	5825	1095	1170	3346	2226	1120	2226	1015	575	845	127	43	54	42	625
137	6	630	6945	1095	1110	4466	2226	2240	2226	1015	515	507	75	21	54	42	515
138	6	630	6945	1095	1110	4466	2226	2240	2226	1015	515	676	101	29	54	42	590
139	6	630	6945	1095	1170	4466	2226	2240	2226	1015	575	1014	152	43	54	42	740

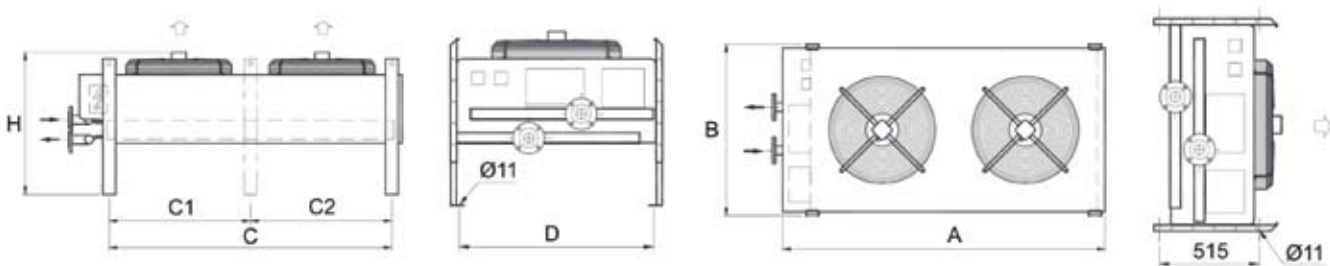

Code description

SJE - 104 - 2 - 350 - 1400 - 3/400/50 - Options

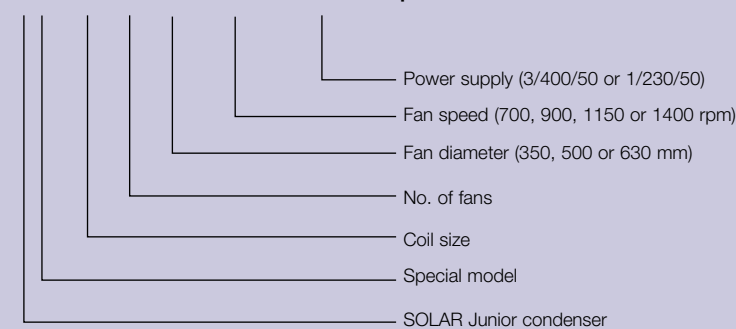

Benefits

- Heavy duty coil & casing materials, resulting in a long operational product life.
- Excellent sound characteristics
- Reliable performance, Eurovent certified.
- Easy-install & maintenance.
- Energy efficient - low total cost of ownership.
- One full year product guarantee.

ERC00133EN 0809

Alfa Laval reserves the right to change specification without prior notification.

How to contact Alfa Laval

Up-to-date Alfa Laval contact details for all countries are always available on our website at www.alfalaval.com

